

**TABLE OF CONTENTS**  
**MID-WAY REGIONAL AIRPORT**  
**TxDOT SOLICITATION No.: RFQ-23ALWAXCH-00005**

1. REQUEST FOR QUALIFICATIONS ANNOUNCEMENT
2. EVALUATION CRITERIA
3. AIRPORT LAYOUT PLAN
4. INSTRUCTIONS FOR RESPONDING TO A SOLICITATION IN EGRANTS
5. [FORM AVN-551](#) (PLEASE BE SURE TO DOWNLOAD THE MOST RECENT REVISED FORM DATED 8/2016)  
<http://www.txdot.gov/inside-txdot/division/aviation/projects.html>

**Texas Department of Transportation**  
**Aviation Division**  
**Request for Qualifications (RFQ) for Professional**  
**Services**

The City of Midlothian and City of Waxahachie through its agent, the Texas Department of Transportation (TxDOT), intends to engage a qualified firm for services. This solicitation is subject to 49 U.S.C. §47107(a)(17) and will be administered in the same manner as a solicitation conducted under Chapter 2254, Subchapter A, of the Texas Government Code. TxDOT Aviation Division will solicit and receive qualification statements for professional services as described below:

Airport Sponsor: City of Midlothian and City of Waxahachie Mid-Way Regional Airport; TxDOT CSJ/Project No.: 23ALWAXCH. The TxDOT Project Manager is Sean Newton.

Scope:

1. Prepare a Master Plan consistent with the most current FAA Advisory Circulars and Standard Operating Procedures, to include incorporating sustainability and recycling, reuse, and waste reduction;
2. Incorporate FAA AGIS requirements and data collection as needed;
3. Develop a Capital Improvement Plan, including a recommended phasing plan and financial overview that considers local, state, federal, and alternative funding sources;
4. Prepare and update the airport property map (Exhibit A) consistent with the most current FAA Advisory Circulars and Standard Operating Procedures;
5. Establish phased, attainable goals for airport improvements and development based on a forecast for aviation demand and current and future critical aircraft;
6. Develop and adopt into local zoning airport height hazard protection and airport land use compatibility measures, including associated maps, to ensure the protection of the public investment in the airport;
7. Per FAA SOP 8.00, review any existing RSA determinations and update as needed or complete a determination for any runway that does not have one. If an RSA study is needed, that study will be conducted as part of this planning effort. A list of follow-on projects or studies will be a deliverable of this task.

The Agent, in accordance with the provisions of Title VI of the Civil Rights Act of 1964 (78 Stat. 252, 42 U.S.C. §§ 2000d to 2000d-4) and the Regulations, hereby notifies all respondents that it will affirmatively ensure that for any contract entered into pursuant to this advertisement, disadvantaged business enterprises will be afforded full and fair opportunity to submit in response to this solicitation and will not be discriminated against on the grounds of race, color, or national origin in consideration for an award.

The proposed contract is subject to 49 CFR Part 26 concerning the participation of Disadvantaged Business Enterprises (DBE).

The DBE goal is set at 0%.

To assist in your qualification statement preparation the criteria, and most recent Airport Layout Plan are available online at <http://www.dot.state.tx.us/avn/avninfo/notice/consult/index.html> by selecting “Mid-Way Regional Airport”.

### **AVN-551 Preparation Instructions:**

Interested firms shall utilize the latest version of Form AVN-551, titled “Qualifications for Aviation Planning Services”. The form may be requested from TxDOT, Aviation Division, 125 E. 11th Street, Austin, Texas 78701-2483, phone number, (800)68-PILOT (74568). The form may be emailed by request or downloaded from the TxDOT website at <http://www.txdot.gov/inside-txdot/division/aviation/projects.html>. The form may not be altered in any way. Firms must carefully follow the instructions provided on each page of the form. Qualifications shall not exceed the number of pages in the AVN-551 template. The AVN-551 consists of eight pages of data plus one optional illustration page. A prime provider may only submit one AVN-551. If a prime provider submits more than one AVN-551, or submits a cover letter with the AVN-551, that provider will be disqualified. Responses to this solicitation WILL NOT BE ACCEPTED IN ANY OTHER FORMAT.

ATTENTION: To ensure utilization of the latest version of Form AVN-551, firms are encouraged to download Form AVN-551 from the TxDOT website as addressed above. Utilization of Form AVN-551 from a previous download may not be the exact same format. Form AVN-551 is a PDF Template.

The completed Form AVN-551 must be received in the TxDOT Aviation eGrants system no later than February 9, 2023, 11:59 PM. (CDST). Electronic facsimiles or forms sent by email or regular/overnight mail will not be accepted.

Firms that wish to submit a response to this solicitation must be a user in the TxDOT Aviation eGrants system no later than one business day before the solicitation due date. To request access to eGrants, please complete the Contact Us web form located at <http://txdot.gov/government/funding/egrants-2016/aviation.html>.

Instructions on how to respond to a solicitation in eGrants are available at <http://txdot.gov/government/funding/egrants-2016/aviation.html>.

Step by step instructions on how to respond to a solicitation in eGrants will also be posted in the RFQ packet at <http://www.dot.state.tx.us/avn/avninfo/notice/consult/index.html>.

The consultant selection committee will be composed of local government representatives. The final selection by the committee will generally be made following the completion of review of AVN-551s. The committee will review all AVN-551s and rate and rank each. The evaluation criteria for airport planning projects can be found at <http://www.txdot.gov/inside-txdot/division/aviation/projects.html> under Information for Consultants. All firms will be notified and the top rated firm will be contacted to begin fee negotiations. The selection committee does, however, reserve the right to conduct interviews for the top rated firms if the committee deems it necessary. If interviews are conducted, selection will be made following interviews.

Please contact TxDOT Aviation for any technical or procedural questions at (800) 68-PILOT (74568). For procedural questions, please contact Noemi Rios, Grant Manager. For technical questions please contact Sean Newton, Project Manager.

For questions regarding responding to this solicitation in eGrants, please contact the TxDOT Aviation help desk at 1-800-687-4568 or [avn-egrantshelp@txdot.gov](mailto:avn-egrantshelp@txdot.gov).



## EVALUATION CRITERIA FOR AIRPORT PLANNING QUALIFICATIONS

The following criteria will generally be used in evaluating consultants submitting qualifications; however, the Consultant Selection Committee may develop additional consultant evaluation criteria and point values, if desired. The Consultant Selection Committee should assign points to be used for the Consultant Rating Sheet if they do not use the suggested point values. The TxDOT Project Manager can assist the Selection Committee in interpreting the criteria and establishing point values for each criterion, if necessary.

### Suggested Point Values and Selection Criteria

- 1. Capability to perform all of the services required for this project and professional qualifications of key personnel assigned to this project relevant to the work to be performed. (25 points)**

Does the consultant have the necessary resources to perform all of the services required (e.g.: planning, surveying, CAD, etc.)? Who are the professionals that will be working on this project on a daily basis and how do their qualifications and experience with general aviation airport planning projects compare with other respondents? [Sources of information: Aviation Planning Team Form, Recent Relevant Airport Experience Form, Proposed Technical Approach Form, and possibly the Optional Summary.]
- 2. Recent experience, within the last ten years, in the development of airport plans comparable to the proposed project. (25 points)**

Does the consultant have direct experience developing general aviation airport plans similar to those proposed for this location? [Sources of information: Aviation Planning Team Form, Recent Relevant Airport Experience Form, and possibly the Optional Summary.]
- 3. Ability to meet the schedules and deadlines of this project and reputation for competence, timeliness, and quality of performance and work product. (25 points)**

Does the proposed planning team have sufficient time to devote to this project in order to meet the schedule submitted in the qualifications? Is the proposed schedule realistic? Does the consultant consistently meet contractual timetables? Has the work performed for other airports been satisfactory? [Sources of information: Aviation Planning Team Form, Recent Relevant Airport Experience Form, Project Schedule Form, possibly the Optional Summary, and reference check.]

**4. Proposed Technical Approach and Schedule to Accomplish the Project. (25 points)**

Does the consultant show specific understanding and familiarity with the particular requirements of this project and how to address them? Is the consultant familiar with relevant planning guidance? Is the schedule appropriate to accomplish the project?

[Sources of information: Proposed Technical Approach Form, Proposed Schedule Form, and possibly the Optional Summary.]

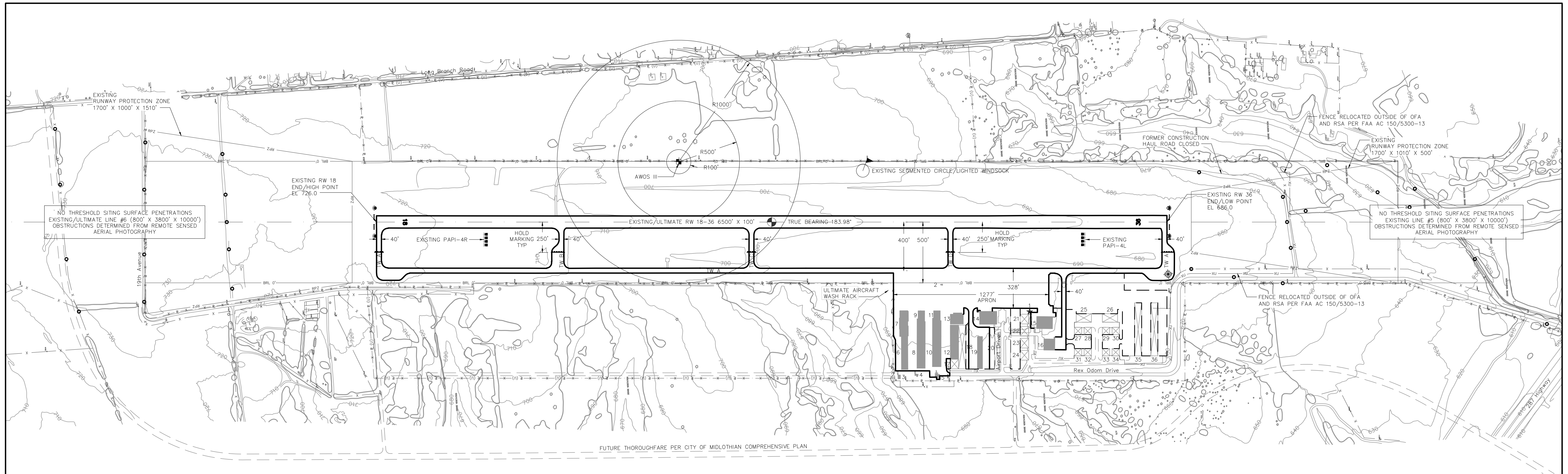

NO THRESHOLD SITING SURFACE PENETRATIONS  
EXISTING/ULTIMATE LINE #6 (800' X 3800' X 10000')  
OBSTRUCTIONS DETERMINED FROM REMOTE SENSED  
AERIAL PHOTOGRAPHY

NO THRESHOLD SITING SURFACE PENETRATIONS  
EXISTING LINE #5 (800' X 3800' X 10000')  
OBSTRUCTIONS DETERMINED FROM REMOTE SENSED  
AERIAL PHOTOGRAPHY

FUTURE THOROUGHFARE PER CITY OF MIDLOTHIAN COMPREHENSIVE PLAN

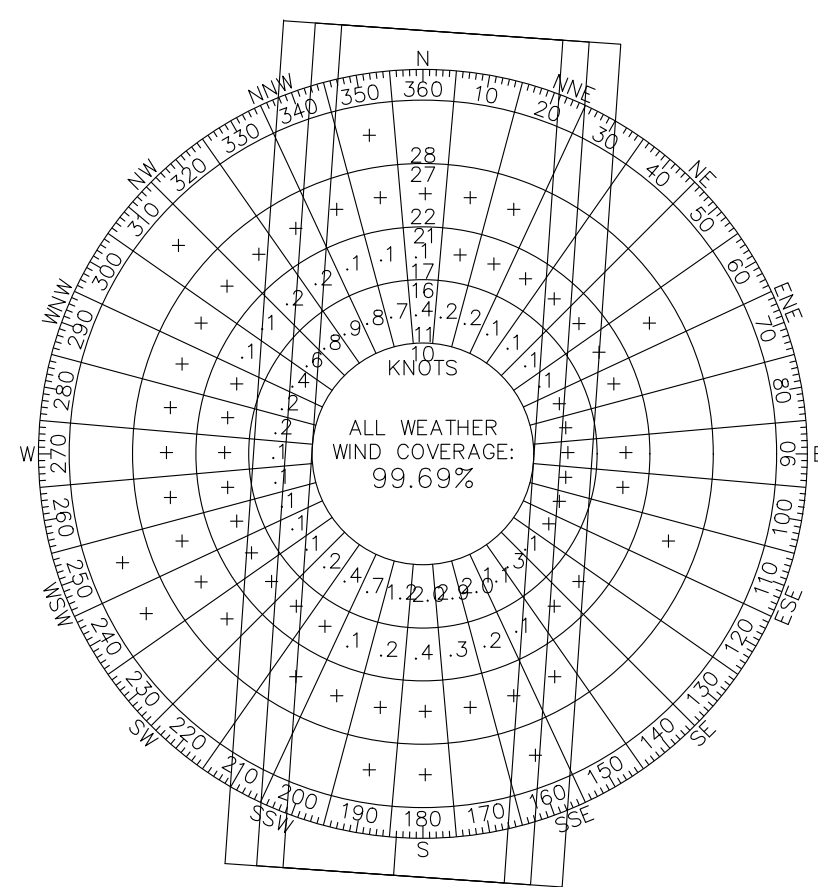

MAGNETIC DECLINATION  
3° 54' 53" E (JULY 2012)  
ANNUAL RATE OF CHANGE  
0° 7.9' W (JULY 2012)

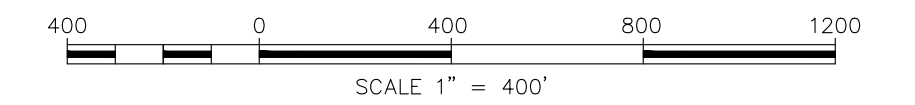

BUILDING TABLE			
BUILDING NUMBER	DESCRIPTION		TOP ELEVATION
	EXISTING	ULTIMATE	
1	ROTATING BEACON		744.2'
2	SELF-SERVICE FUEL FACILITY		698.9'
3	AIRPORT MAINTENANCE FACILITY		697.5'
4	CIVIL AIR PATROL		698.3'
5	FUEL FARM		695.8'
6	T-HANGARS		705.0'
7	BOX HANGARS		717.0'
8	T-HANGARS		705.0'
9	BOX HANGAR		716.6'
10	T-HANGARS		705.0'
11	BOX HANGAR		713.8'
12	BOX HANGARS		722.8'
13	BOX HANGAR		720.4'
14	TERMINAL BUILDING/ CONVENTIONAL HANGAR		722.6'
15	CONVENTIONAL HANGAR		728.1'
16	BOX HANGAR		721.5'
17		BOX HANGARS	727.0'
18		BOX HANGARS	722.8'
19		T-HANGARS	-
20		BOX HANGARS	722.8'
21		EXECUTIVE HANGAR	709.0'
22		EXECUTIVE HANGAR	708.0'
23		EXECUTIVE HANGAR	705.0'
24		EXECUTIVE HANGAR	703.0'
25		CONVENTIONAL HANGAR	724.0'
26		CONVENTIONAL HANGAR	723.0'
27		EXECUTIVE HANGAR	705.0'
28		EXECUTIVE HANGAR	705.0'
29		EXECUTIVE HANGAR	703.5'
30		EXECUTIVE HANGAR	703.0'
31		EXECUTIVE HANGAR	703.0'
32		EXECUTIVE HANGAR	703.0'
33		EXECUTIVE HANGAR	702.5'
34		EXECUTIVE HANGAR	702.5'
35		T-HANGARS	705.0'
36		T-HANGARS	704.0'

AIRPORT DATA TABLE		
	EXISTING	ULTIMATE
AIRPORT ELEVATION (MSL)	727.0'	727.0'
AIRPORT NAVIGATION AIDS	GPS	GPS
MEAN MAX TEMP (Hottest Month F)	97F	97F
AIRPORT REFERENCE CODE (ARC)	C-II	C-II
TAXIWAY MARKING	STD W/REF	STD W/REF
TAXIWAY LIGHTING	NONE	NONE
AIRPORT REFERENCE POINT COORDINATES	32°27'29.9" N 96°54'45.1" W	32°27'29.9" N 96°54'45.1" W

**NOTES**

SURVEY MAPPING PERFORMED BY GEODETIX, INC., SAN ANTONIO, TX, SEPTEMBER 2011. A SURVEY THAT COMPLIES WITH FAA AC 150/5300-16, 17, AND 18 WAS NOT PERFORMED.

DATUM COORDINATE SYSTEMS - HORIZONTAL DATUM NAD 1983 State Plane Texas North Central Zone 4202 Feet, VERTICAL DATUM NAVD88.

EXISTING RUNWAY COORDINATES AND END ELEVATIONS FROM AVIATION STANDARD INFORMATION SYSTEM (ASIS), <http://avwww.fccbi.gov/datasheet/>

THERE ARE NO PRIMARY OR SECONDARY AIRPORT CONTROL STATIONS FOR MID-WAY REGIONAL AIRPORT.

THE EXISTING HEIGHT HAZARD ZONING ORDINANCE FOR MID-WAY REGIONAL AIRPORT: RUNWAY 18-36 IS 6500'. NO CIRCLE ZONING, AS OF 9 APRIL 2009, AS PROVIDED BY TEXAS DEPARTMENT OF TRANSPORTATION.

CAUTION ZONE LIGHTS ARE PRESENT AT MID-WAY REGIONAL AIRPORT.

NO OFZ OBJECT PENETRATIONS

ULTIMATE SECURITY FENCING SHALL BE INSTALLED AS A PHYSICAL ACCESS BARRIER TO TERMINAL AREAS.

RUNWAY 18-36 PAVEMENT STRENGTH WAS UPGRADED TO 90,000 DW AS PART OF THE RUNWAY REHABILITATION PROJECT COMPLETED IN 2011.

RUNWAY END COORDINATES AND ELEVATIONS			
RUNWAY END	LATITUDE	LONGITUDE	ELEVATION
EXISTING END OF RWY 18	32°28'01.93" N	96°54'42.46" W	726.0'
EXISTING END OF RWY 36	32°26'57.77" N	96°54'47.73" W	686.0'

	RW 18-36			
	EXISTING	EXISTING	ULTIMATE	ULTIMATE
<b>RUNWAY ARC</b>	C-II	C-II	C-II	C-II
DESIGN AIRCRAFT & ARC	Challenger 604	Challenger 604	Challenger 604	Challenger 604
BALANCED FIELD LENGTH	5702'	5702'	5702'	5702'
RUNWAY LENGTH & WIDTH (ft.)	6500' X 100'	6500' X 100'	6500' X 100'	6500' X 100'
PAVEMENT DESIGN STRENGTH (1000 lbs.)	30 SW 90 DW	30 SW 90 DW	30 SW 90 DW	30 SW 90 DW
RUNWAY LIGHTING	MIRL	MIRL	MIRL	MIRL
PERCENT EFFECTIVE GRADIENT	0.6%	0.6%	0.6%	0.6%
PERCENT WIND COVERAGE	99.69% 16 kts	99.69% 16 kts	99.69% 16 kts	99.69% 16 kts
MAXIMUM ELEVATION ABOVE MSL	726.0'	726.0'	726.0'	726.0'
RW SURFACE TYPE	ASPH/CONCRETE	ASPH/CONCRETE	ASPH/CONCRETE	ASPH/CONCRETE
RSA - LENGTH BEYOND RW END	1000'	1000'	1000'	1000'
RSA - WIDTH	500'	500'	500'	500'
OFA - LENGTH BEYOND RW END	1000'	1000'	1000'	1000'
OFA WIDTH	800'	800'	800'	800'
OFZ - LENGTH BEYOND RW END	200'	200'	200'	200'
OFZ WIDTH	400'	400'	400'	400'
<b>RUNWAY END</b>	18	36	18	36
APPROACH TYPE	GPS LPV	GPS LPV	GPS LPV	GPS LPV
APPROACH VISIBILITY MINIMA	3/4 MILE	1 MILE	3/4 MILE	1 MILE
THRESHOLD SITING SURFACE & SLOPE	#6 20:1	#5 20:1	#6 20:1	#5 20:1
RUNWAY MARKING	NPI	NPI	PIR	NPI
RUNWAY VISUAL AIDS	PAPI-4 REILS	PAPI-4 REILS	PAPI-4 REILS	PAPI-4 REILS
TOUCHDOWN ZONE ELEVATION	726.0'	702.6'	726.0'	702.6'
FAR PART 77 APPROACH CATEGORY	D	C	D	C
FAR PART 77 APPROACH SURFACE SLOPE	34:1	34:1	34:1	34:1
TAKE-OFF RUN AVAILABLE (TORA)	6500'	6500'	6500'	6500'
TAKE-OFF DISTANCE AVAILABLE (TODA)	6500'	6500'	6500'	6500'
ACCELERATE STOP DISTANCE AVAIL. (ASDA)	6500'	6500'	6500'	6500'
LANDING DISTANCE AVAILABLE (LDA)	6500'	6500'	6500'	6500'

ALD LEGEND		
FEATURE	EXISTING	ULTIMATE
RUNWAY/TAXIWAY OUTLINE	=====	-----
RUNWAY/TAXIWAY TO BE REMOVED	=====	-----
BUILDINGS/FACILITIES	█	█
AIRPORT PROPERTY LINE	---	---
AIRPORT PROPERTY LINE w/FENCE	--- ---	--- ---
FENCE LINE	--- ---	--- ---
BUILDING RESTRICTION LINE (BRL)	---	---
AIRPORT REFERENCE POINT	⊙	⊙
WIND CONE & SEGMENTED CIRCLE	⊙	⊙
THRESHOLD LIGHTS	●●●●	●●●●
RW END IDENTIFIER LIGHTS (REILS)	●	●
C&G BEACON	★	★
VGSI	⊙	⊙
HOLD POSITION AND SIGN	■	■
AWOS	■	■
SURVEY MARKERS	▽	▽
GROUND CONTOURS	~	~
SIGNIFICANT OBJECT LOCATION	○	○
TREES/BRUSH	○	○
NONDIRECTIONAL BEACON (NDB)	⊙	⊙

REVISIONS			
NUM	DESCRIPTION	BY	DATE
1	EXPAND NORTH AND MIDDLE APRON AREAS	TxDOT - MACKIE	JAN 2014
2	CHANGE HANGAR 19 FROM ULT TO EXIST. ADD PAVEMENT	TxDOT - MACKIE	JUN 2018

**TEXAS DEPARTMENT OF TRANSPORTATION  
AVIATION DIVISION**

ALP APPROVED ACCORDING TO FAA AC 150/5300-13 CHANGE 18 PLUS THE REQUIREMENTS OF A FAVORABLE ENVIRONMENTAL FINDING AND FAA NRA STUDY PRIOR TO THE START OF ANY LAND ACQUISITION OR CONSTRUCTION ON AIRPORT PROPERTY.

COPYRIGHT 2012 TEXAS DEPARTMENT OF TRANSPORTATION. ALL RIGHTS RESERVED.

**AIRPORT SPONSOR**

CURRENT AND FUTURE DEVELOPMENT DEPICTED ON THIS ALP IS APPROVED AND SUPPORTED BY AIRPORT SPONSOR

SPONSOR ACKNOWLEDGES APPROVAL OF ALP BY TxDOT DOES NOT CONSTITUTE A COMMITMENT TO FUNDING.

DAVID FULTON, DIRECTOR, AVIATION DIVISION      DATE \_\_\_\_\_      SIGNATURE \_\_\_\_\_      DATE \_\_\_\_\_

FILE: AIRPORT SPONSOR'S REPRESENTATIVE

FILE: AIRPORT SPONSOR'S REPRESENTATIVE

**PREPARED BY:**  
237 N.W. Blue Parkway  
Suite 100  
Lee's Summit, Mo. 64063  
(816) 524-3500, Fax (2575)  
Coffman Phoenix Office:  
4835 E. Cactus Road  
Suite 235  
Scottsdale, Az. 85254  
(602) 993-6999, Fax (7196)

**Coffman Associates  
Airport Consultants  
www.coffmanassociates.com**

M. QUICK DESIGNED BY      SEPTEMBER 27, 2012 DATE  
D. HOPKINS DRAWN BY      SEPTEMBER 27, 2012 DATE

**AIRPORT LAYOUT DRAWING  
MID-WAY REGIONAL AIRPORT  
MIDLOTHIAN/WAXAHACHIE, TEXAS (JWY)**

Texas Department of Transportation  
Aviation Division

SHEET 1 OF 4





# Instructions for Responding to an RFQ Solicitation

Aviation Division

eGrants Workflow:	RFQ Response
eGrants Role:	Subgrantee Administrator (SA) Subgrantee Staff (SS)
eGrants link	<a href="https://apps2.dot.state.tx.us/apps/egrants2/logout2.aspx">https://apps2.dot.state.tx.us/apps/egrants2/logout2.aspx</a>
eGrants help:	eGrants help desk Monday – Friday 8AM – 4PM CD/ST (excluding state/federal holidays) <a href="mailto:avn-egrantshelp@txdot.gov">avn-egrantshelp@txdot.gov</a> or 1-800-687-4568

STEP	ROLE	ACTIONS	NOTES
01	SA	Go to View Opportunities. a. Select <u>Apply Now</u> to the opportunity b. The RFQ Response Menu is opened	Very important to click on the name of the document and not the organization name  Make a note of the opportunity due date to ensure you respond in time
02	SA/SS	Click on View, Edit and Complete Forms a. Select RFQ Applicant Form b. Confirm Project information and address c. Upload AVN-550, 550D, 551 or 551D <u>PLEASE MAKE SURE YOU SELECT THE CORRECT PDF FILE BEFORE CHANGING STATUS.*</u> d. Hit Save	You should print the proposal document to a PDF so that it becomes un-editable. Or, you may upload a scanned copy of the AVN-550, 550D, 551, or 551D.
03	SA	When you are ready to submit your response, click on Save and submit to CS review <u>YOU ARE DONE</u>	You will get an email saying the response was successfully submitted; the status must be changed to RFQ Response in CS Review by the due date and time posted in the solicitation.
04	SA/SS	<u>WAIT</u> UNTIL A SELECTION NOTIFICATION IS SENT TO YOU	
05	SS/SA	<u>AFTER SELECTION NOTIFICATION IS RECEIVED</u> Log in to view status of response. Once the scores are verified, TxDOT will move the response to an interview, selected or not selected status of which you can log in to see the status of your response.	The selection notification will refer users to eGrants to view the status of their response. User may also view the TxDOT website for selection information.



\*If the responder posts the incorrect file.

- If status has been changed and the due date for the response has not expired, contact the help desk to ask for the status to be administratively changed back to Response in Process.
- If the incorrect file was posted, the incorrect file may be deleted and the correct one posted as long as the status has not been changed to Response in CS Review. Respondent will need to check the “delete” box and hit save. The page refreshes. Then post the correct file, save, and change the status.

If you are not set up in eGrants and wish to respond to a posted solicitation, you may contact the aviation help desk for assistance by using the webform available at [eGrants Help Desk Form](#)

Some organizations will have many user members. Each organization should determine which user member will submit the completed avn-550, 550D, 551, or 551D in eGrants. after the opportunity is selected for the organization, it will no longer appear on any other user's home page unless the initiating user cancels the response.