

TABLE OF CONTENTS
GAINES COUNTY AIRPORT
TxDOT SOLICITATION No.: RFQ2405SEMNL-00081

1. REQUEST FOR QUALIFICATIONS SOLICITATION
2. EVALUATION CRITERIA
- 3 INSTRUCTIONS FOR RESPONDING TO A SOLICITATION IN EGRANTS
4. PROJECT DIAGRAM
5. AIRPORT LAYOUT PLAN

**Texas Department of Transportation
Aviation Division
Request for Qualifications (RFQ) for
Professional Engineering Services**

Gaines County, through its agent, the Texas Department of Transportation (TxDOT), intends to engage a professional engineering firm for services pursuant to Chapter 2254, Subchapter A, of the Government Code. TxDOT Aviation Division will solicit and receive qualification statements for the current aviation project as described below.

Current Project: Gaines County; TxDOT CSJ/Project ID: 2405SEMNL.
The TxDOT Project Manager is Paul Slusser.

Scope: Provide engineering and design services, including construction administration, to:

1. Reconstruct Runway 08/26
2. Reconstruct Terminal Apron
3. Reconstruct Taxiway D and Taxiway connectors to RWY 17/35
4. Sealcoat and Mark RWY 17/35

The Agent, in accordance with the provisions of Title VI of the Civil Rights Act of 1964 (78 Stat. 252, 42 U.S.C. §§ 2000d to 2000d-4) and the Regulations, hereby notifies all respondents that it will affirmatively ensure that for any contract entered into pursuant to this advertisement, disadvantaged business enterprises will be afforded full and fair opportunity to submit in response to this solicitation and will not be discriminated against on the grounds of race, color, or national origin in consideration for an award.

The proposed contract is subject to 49 CFR Part 26 concerning the participation of Disadvantaged Business Enterprises (DBE).

The DBE goal for the design phase of the current project is **11%**. The goal will be re-set for the construction phase.

To assist in your qualification statement preparation, the criteria, project diagram, and most recent Airport Layout Plan are available online at <http://www.dot.state.tx.us/avn/avninfo/notice/consult/index.html> by selecting “Gaines County Airport.” The qualification statement should address a technical approach for the current scope only.

Response Procedure:

The successful firms will be selected on the basis of a Response. A prime provider may only submit one Response. If a prime provider submits more than one Response, that prime provider will be deemed non-responsive. The Response must contain the required information, and should address

the recommended information, as listed below. Response submissions will be scored accordingly. If the Response is non-compliant with any of the following requirements, the Response may be deemed non-responsive.

1. Qualifications Statement (QS) – The QS shall contain no more than **nine 8.5x11-inch single-sided pages.**
 - a. QS Format:
 - i. Readability – The submitter has latitude in formatting the QS for visual effectiveness. Graphics, tables, photos, and other visual aids are permitted within the nine allotted pages, except that Quick Response (QR) codes or other external link(s) are not permitted. There is no specific font, font size, color, or other formatting requirements, although a font size smaller than 10 is not recommended. Selection committee members may consider legibility and readability when scoring. Unreadable text will not be considered and may cause the QS to be deemed non-responsive. **It is the submitter's responsibility to provide a legible, readable document.**
 - b. QS Content - It is recommended the QS include:
 - i. The RFQ number, airport name, name of firm, firm address, email address, telephone number and contact information for key personnel. The response shall also identify each proposed project team member, each proposed member's time commitment to this project as a percentage of their total work week, and whether the proposed member is an employee of the responding firm or a sub-contractor to that firm.
 - c. QS Content – For scoring purposes, the QS **must** include:
 - i. Information showing the firm's project understanding and technical approach, including similar project-related experience of the project manager and each task leader responsible for a major work category. For each project referenced, identify either the project manager's or the task leader's specific role(s) and work contributed. The project manager is required to be a Professional Engineer registered or licensed in Texas, by the submission deadline. If applicable to project, an Architect, is required to be registered or licensed in Texas, by the submission deadline. License number(s) must be included in the response submission.
 - ii. In addition to individual project-related experience of the project manager and task leaders required under (ii), list no more than ten relevant projects performed by the responding firm within the last 10 years. This shall include project start date, airport name, location, phone number, and airport

contact person's name, title, and phone number. It shall also include the original project completion time estimate vs. the actual completion time for the cited design project, as well as a brief narrative description of the project and whether or not your firm served as the prime or the sub on each project cited.

- iii. Project Design Schedule: Indicate the number of **weeks** (not months) necessary to design the project in accordance with "Project Design Schedule Information" below.

The Response must be submitted in eGrants following the Submission Procedures at the end of this notice.

Project Design Schedule Information

Based on the published project scope and your technical approach, indicate the number of **weeks** (not months) necessary for each phase and total design time to design the project. Some of the basic responsibilities within each design phase are included for reference. Do not include TxDOT review time. Assume, however, that your work will require some revision after TxDOT review, and that the time required to address these comments should be included within your schedule. If time is required for specialized studies, indicate the additional time.

NOTE: This proposed schedule will set the basis for the contract deadlines in the professional services agreement if your firm is selected.

Preliminary Report Phase

Attend pre-design conference
Obtain and analyze necessary survey data
Obtain and analyze necessary geotechnical data
Prepare comprehensive report

Preliminary Design Phase

Attend project meeting(s)
Prepare project drawings (70%)
Provide all technical specifications
Provide project cost estimate

Final Design Phase

Attend project meeting(s)
Finalize drawings and contract documents (100%)
Provide a revised opinion of probable total project costs
Prepare a Construction Management Plan
Update, if necessary, the Preliminary Report
Prepare and submit airspace study to FAA

Evaluation Criteria for Architectural/Engineering Qualifications

1. Recent experience of the project team with comparable airport projects within the past ten years. (25 points)

Do the qualifications indicate that the project team has recent direct experience on other general aviation airports designing similar improvements to those proposed at this location?

2. Proposed technical approach (30 points)

Does the architect/engineer provide evidence of understanding of the project; and any unique architectural/engineering aspects associated with the proposed project and how to address them?

3. Project design schedule and ability to meet schedules and deadlines (25 points)

Does the proposed design team have sufficient time to work on this project? Has the firm demonstrated an ability to meet design schedules in the past? Reasonableness of proposed schedule.

4. Construction Management Experience (20 points)

The architect/engineer will oversee the airport construction. Therefore, it is critical that the architect/engineer be involved in the day-to-day construction activities through a full-time resident project representative and periodic site visits. What evidence do the qualifications provide as to the architect/engineer's commitment to proactive and consistent representation during construction?

Submission Procedure:

The completed Response must be received in the TxDOT Aviation eGrants system no later than **December 31, 2024, 2:00 p.m. (CST)**.

Firms that wish to submit a Response to this solicitation must be a user in the TxDOT Aviation eGrants system no later than one business day before the solicitation due date. To request access to eGrants, please complete the Contact Us web form located at <http://txdot.gov/government/funding/egrants-2016/aviation.html>

The consultant selection committee will be composed of local government representatives. The final selection by the committee will generally be made following the completion of review of Responses. The committee will review all Responses and rate and rank each. All firms will be notified, and the top-rated firm will be contacted to begin fee negotiations for the design and bidding phases. The selection committee does, however, reserve the right to conduct interviews for the top-rated firms if the committee deems it necessary. If interviews are conducted, selection will be made following interviews.

Please contact TxDOT Aviation for any technical or procedural questions at 1-800-68-PILOT (74568). For procedural questions, please contact Noemi Rios, Contract Specialist. For technical questions, please contact Paul Slusser, Project Manager.

For questions regarding responding to this solicitation in eGrants, please contact the TxDOT Aviation help desk at 1-800-687-4568 or avn-egrantshelp@txdot.gov.

Respondents are responsible for checking the TxDOT Aviation website regularly for any changes to the RFQ documents, such as Addenda. Here is a link to the TxDOT Aviation website for your convenience at <http://www.txdot.gov/inside-txdot/division/aviation/projects.html>.



Aviation Division

eGrants Workflow:	RFQ Response		
eGrants Role:	Subgrantee Administrator (SA) Subgrantee Staff (SS)		
eGrants link	https://apps2.dot.state.tx.us/apps/egrants2/logout2.aspx		
eGrants help:	eGrants help desk Monday – Friday 8AM – 4PM CD/ST (excluding state/federal holidays) avn-egrantshelp@txdot.gov or 1-800-687-4568		
STEP	ROLE	ACTIONS	NOTES
01	SA	Go to View Opportunities. a. Select <u>Apply Now</u> to the opportunity b. The RFQ Response Menu is opened	Very important to click on the name of the document and not the organization name. Make a note of the opportunity due date to ensure you respond in time
02	SA/SS	Click on View, Edit and Complete Forms a. Select RFQ Applicant Form b. Confirm Project information and address c. Upload RFQ response <u>PLEASE MAKE SURE YOU SELECT THE CORRECT PDF FILE BEFORE CHANGING STATUS.*</u> d. Hit Save	You should print the proposal document to a PDF so that it becomes un-editable.
03	SA	When you are ready to submit your response, click on <u>"Save and submit to CS review"</u> . YOU ARE DONE	You will get an email saying the response was successfully submitted; the status must be changed to RFQ Response in CS Review by the due date and time posted in the solicitation.
04	SA/SS	WAIT UNTIL A SELECTION NOTIFICATION IS SENT TO YOU	
05	SS/SA	<u>AFTER SELECTION NOTIFICATION IS RECEIVED</u> Log in to view status of response. Once the scores are verified, TxDOT will move the response to an interview, selected or not selected status of which you can log in to see the status of your response.	The selection notification will refer users to eGrants to view the status of their response. User may also view the TxDOT website for selection information.

*If the responder posts the incorrect file.

- If status has been changed and the due date for the response has not expired, contact the help desk to ask for the status to be administratively changed back to Response in Process.
- If the incorrect submission was posted, the incorrect file may be deleted and the correct one posted as long as the status has not been changed to Response in CS Review. Respondent will need to check the “delete” box and hit save. The page refreshes. Then post the correct submission, save, and change the status.

If you are not set up in eGrants and wish to respond to a posted solicitation, you may contact the aviation help desk for assistance by using the webform available at

[eGrants Help Desk Form](#)

Some organizations will have many user members. Each organization should determine which user member will submit the completed submission in eGrants. After the opportunity is selected for the organization, it will no longer appear on any other user’s home page unless the initiating user cancels the response.

Gaines County

Legend

 Reconstruct RWY 08/26, TWY D, Apron and Connectors

 Sealcoat and mark RWY 17/35

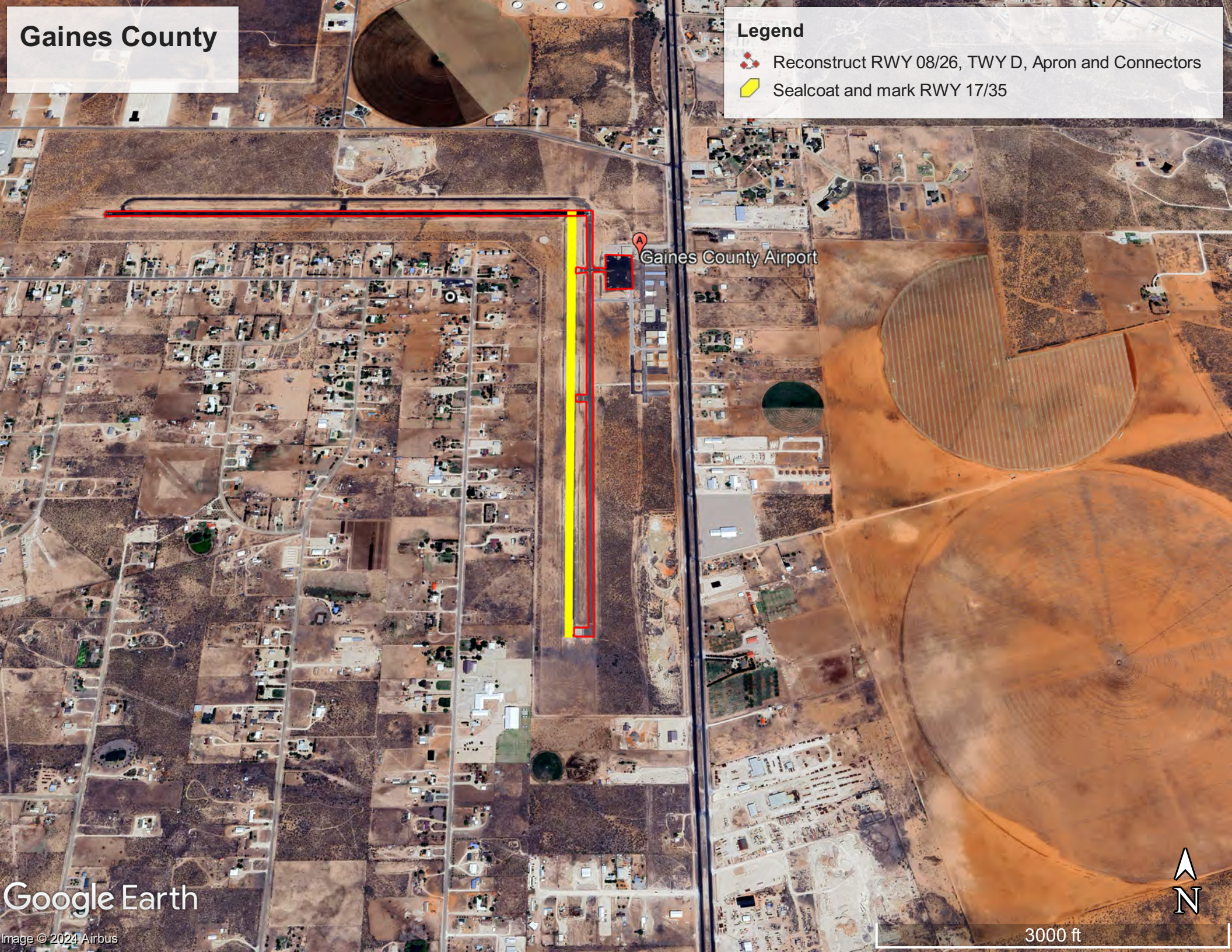

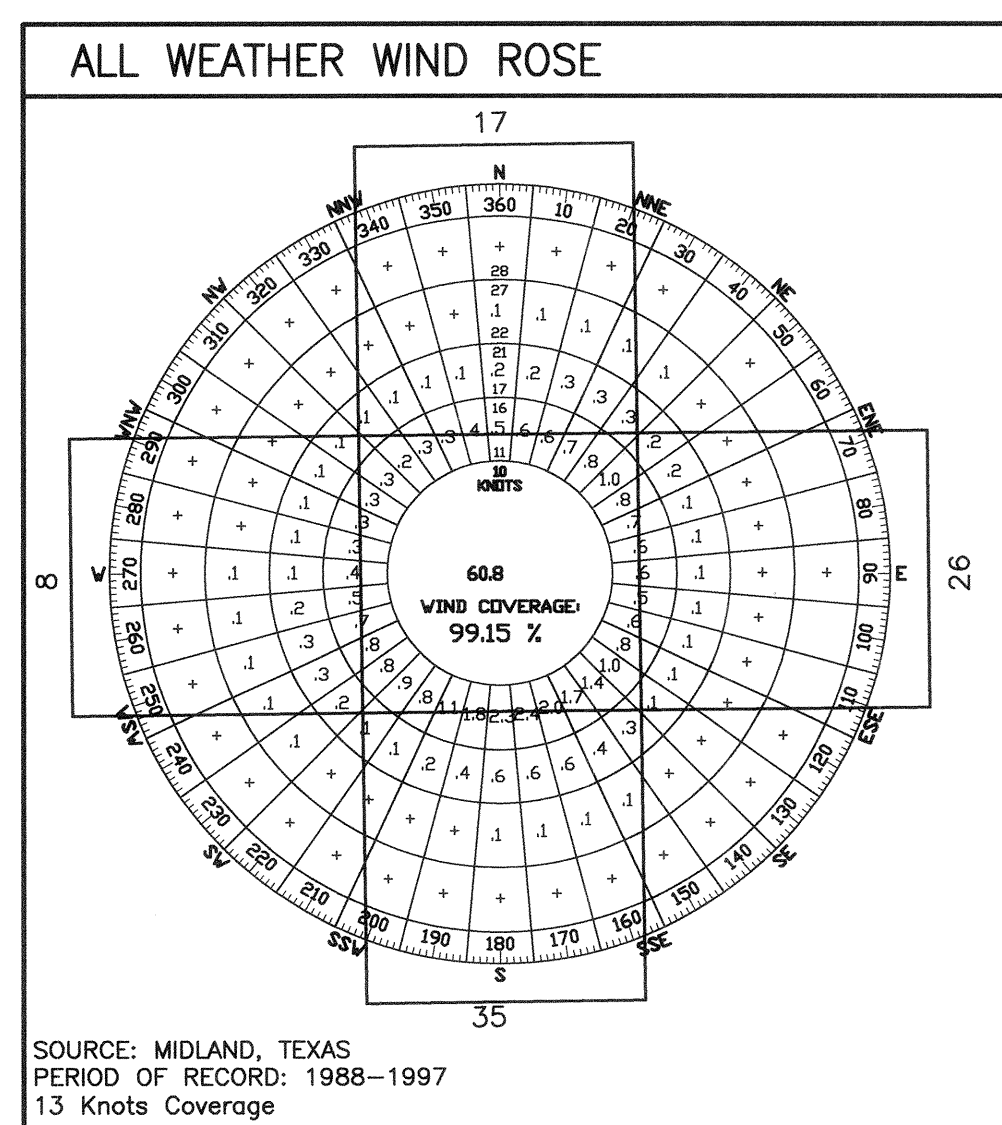











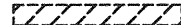

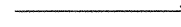
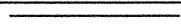
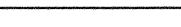
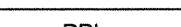

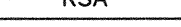
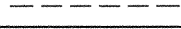

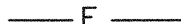
GENERAL NOTES

1. BUILDING RESTRICTION LINES (BRL) ENCOMPASS THE RUNWAY PROTECTION ZONES, THE RUNWAY OBJECT FREE AREA, AND THE RUNWAY VISIBILITY ZONE. THE BRL'S ARE SET FOR THE ULTIMATE RUNWAY CONDITION.

THE BRL'S AT GAINES COUNTY AIRPORT HAVE BEEN ESTABLISHED TO PROTECT PART 77 IMAGINARY OBSTACLE CLEARANCE FOR AN OBJECT THAT IS 0, 2 OR 3 FEET IN HEIGHT. OBJECT OF LESSER HEIGHT MAY BE MOVED CLOSER TO THE RUNWAY CENTERLINE, AS LONG AS THE RESTRICTIONS INDICED IN THE PARAGRAPH ABOVE HAVE BEEN MET. PRIOR TO CONSTRUCTING ANY BUILDING OR OBJECT ON THE AIRPORT, A F.A.R. PART 77 OBSTRUCTION EVALUATION SHOULD BE CONDUCTED.
2. AIRPORT CONTOURS WERE DERIVED FROM DIGITAL COPIES OF THE U.S.G.S. 7.5 DEGREE SURVEY MAPS.
3. THE FOLLOWING DATA WAS OBTAINED OR DERIVED FROM NOS FORM 292, PREPARED BY THE NATIONAL GEODETIC SURVEY/U.S. DEPARTMENT OF COMMERCE AND NAVY: ELEVATIONS, RUNWAY END COORDINATES, RUNWAY BEARINGS, RUNWAY LENGTHS, AND COORDINATES.
4. HORIZONTAL COORDINATES FOR THIS ALP ARE GEOGRAPHIC, NORTH AMERICAN DATUM 1983 (NAD 83). THE VERTICAL DATUM FOR THIS ALP IS THE NATIONAL GEODETIC VERTICAL DATUM OF 1988 (NAVD 88).
5. MAGNETIC DECLINATION INFORMATION OBTAINED FROM NOAA "GEOMAG" ONLINE.
6. THERE ARE NO OFZ OBJECT PENETRATIONS.
7. THERE ARE NO THRESHOLD SITING SURFACE OBJECT PENETRATIONS.

AIRPORT DATA		
ITEM	EXISTING	ULTIMATE
AIRPORT ELEVATION (MSL)	3315.0	SAME
MEAN MAX. TEMP.	95° (JULY)	SAME
AIRPORT REFERENCE POINT (NAD 1983)	LAT. 32°40'31.22" N LONG. 102°39'09.59" W	SAME
AIRPORT NAVAIDS	NDB RWY 35, GPS 35	NDB, GPS 35, GPS - 17, & 26
AIRPORT REFERENCE CODE (ARC)	B II	SAME
WIND COVERAGE @ 13 KNOTS (RWYS 17-35 & 08-26)	99.15%	SAME
TAXIWAY MARKING	CENTER LINE, REFLECTORS	SAME
TAXIWAY LIGHTING	NONE	SAME

BUILDING TABULATION		
NO.	TYPE	TOP ELEV.(MSL)
1	TERMINAL	3294.81
2	AIRPORT OFFICE	3300.68
3	RESIDENCE	3292.65
4	HANGAR	3292.10
5	HANGAR	3290.14
6	HANGAR	3292.61
7	HANGAR	3289.04
8	HANGAR	3297.87
9	HANGAR	3297.70
10	WELL HOUSE	3288.40
11	FUTURE HANGAR	----

LEGEND		
DESCRIPTION	EXISTING	ULTIMATE
BUILDINGS OR STRUCTURES		
AIRFIELD PAVING		
ROADS & PARKING		
PROPERTY LINE		
BUILDING RESTRICTION LINE		
RUNWAY SAFETY AREA		
RUNWAY PROTECTION ZONE		
CONTOUR (Elevation)		
PROPERTY LINE & FENCE		
ELECTRICAL LINE (OVERHEAD)		
PIPELINE		
THRESHOLD LIGHTS		
VASI/PAPI		
ROTATING LIGHT BEACON		
HOLD LINE MARKINGS (NO SIGNS EXISTING)		
WINDCONE (& SEGMENTED CIRCLE)		
TREE		
REIL		
HOLD POSITION/TAXIWAY EXIT SIGNS		

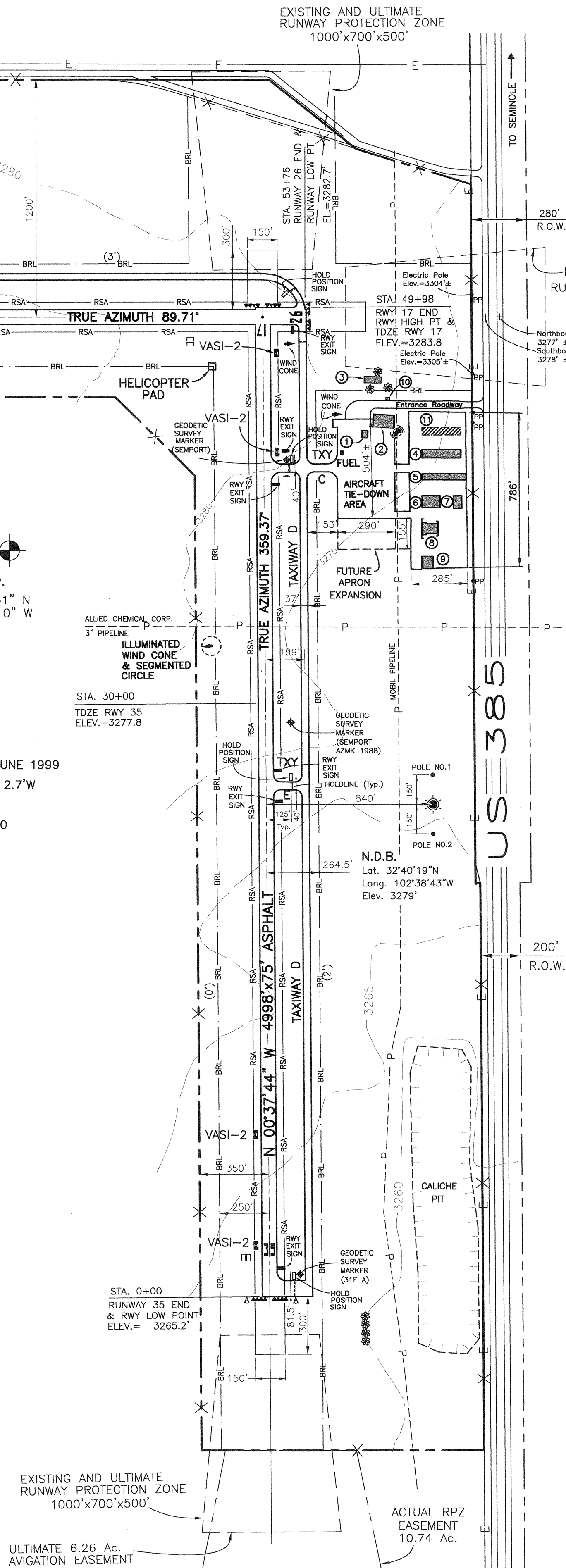
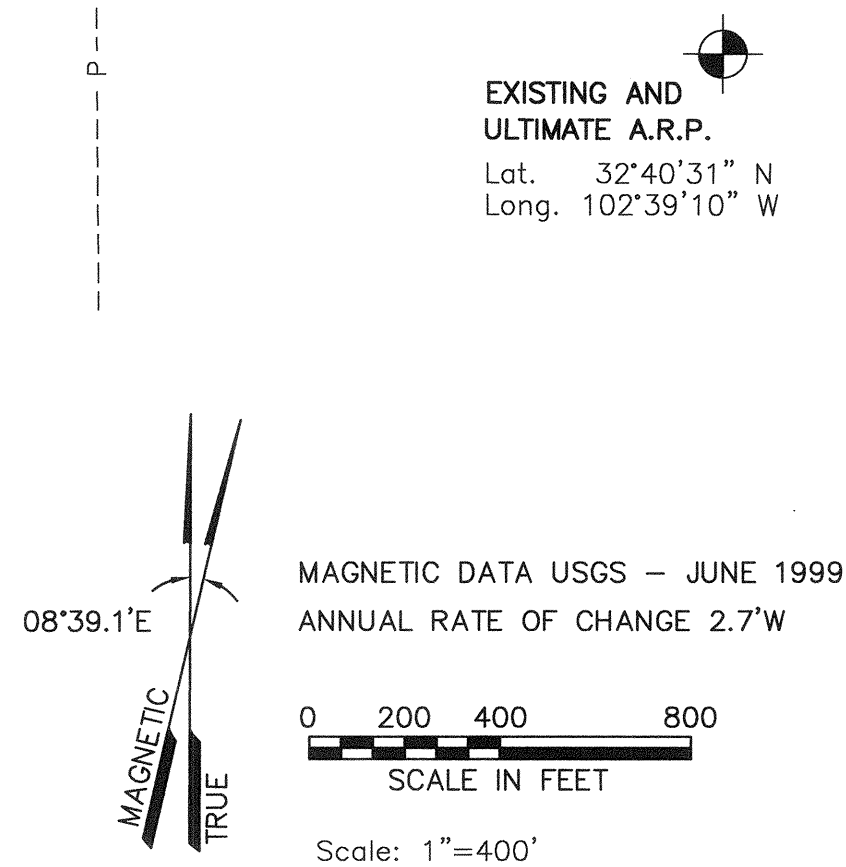

NO.		REVISIONS		BY	CHK'D	DATE
TEXAS DEPARTMENT OF TRANSPORTATION AVIATION DIVISION			AIRPORT SPONSOR			
<input type="checkbox"/> ALP APPROVED ACCORDING TO FAA AC 150/5300-13 CH 5 PLUS THE REQUIREMENTS OF A FAVORABLE ENVIRONMENTAL FINDING PRIOR TO THE START OF ANY LAND ACQUISITION OR CONSTRUCTION AND AN FAA FORM 7460-1 SUBMITTED PRIOR TO ANY CONSTRUCTION ON AIRPORT PROPERTY			CURRENT AND FUTURE DEVELOPMENT DEPICTED ON THIS ALP IS APPROVED AND SUPPORTED BY AIRPORT SPONSOR			
<input type="checkbox"/> ALP APPROVED ACCORDING TO FAA AC 150/5300-13 CH 5 PLUS THE CONDITIONS/COMMENTS IN LETTER DATED: _____			GAINES COUNTY JUDGE TITLE: AIRPORT SPONSOR REPRESENTATIVE _____ JUDY RAY SIGNATURE			
DIRECTOR, AVIATION DIVISION _____ DATE 3/17/00			3-1-00 DATE			
PREPARED BY: <u>Parkhill, Smith & Cooper, Inc.</u> Engineers Architects Planners 5214 Thomason Drive Midland, Texas			DGW 12/16/99 DESIGNED BY DATE AMK 12/16/99 DRAWN BY DATE RWK 12/16/99 CHECKED BY DATE			
AIRPORT LAYOUT PLAN GAINES COUNTY AIRPORT SEMINOLE, TEXAS			 SHEET 1 OF 9			