

**TABLE OF CONTENTS**  
**HOUSTON COUNTY AIRPORT**  
**TxDOT SOLICITATION No.: RFQ-2511CROCK-00079**

1. REQUEST FOR QUALIFICATIONS SOLICITATION
2. EVALUATION CRITERIA
- 3 INSTRUCTIONS FOR RESPONDING TO A SOLICITATION IN EGRANTS
4. PROJECT EXHIBIT
5. AIRPORT LAYOUT DRAWING

**Texas Department of Transportation  
Aviation Division  
Request for Qualifications (RFQ) for  
Professional Engineering Services**

Houston County, through its agent, the Texas Department of Transportation (TxDOT), intends to engage a professional engineering firm for services pursuant to Chapter 2254, Subchapter A, of the Government Code. TxDOT Aviation Division will solicit and receive qualification statements for the current aviation project as described below.

**Current Project:** Houston County; TxDOT CSJ/Project No.: 2511CROCK

The TxDOT Project Manager is Ryan Hindman, P.E.

Scope: Provide engineering and design services, and at the agent's discretion, construction administration to:

1. Install medium intensity runway lights (MIRL) Runway 2/20;
2. Install precision path indicator lights (PAPI) to Runway 2/20;
3. Install new vault;
4. Install new signs; and
5. Install miscellaneous eligible items.

The Agent, in accordance with the provisions of Title VI of the Civil Rights Act of 1964 (78 Stat. 252, 42 U.S.C. §§ 2000d to 2000d-4) and the Regulations, hereby notifies all respondents that it will affirmatively ensure that for any contract entered into pursuant to this advertisement, disadvantaged business enterprises will be afforded full and fair opportunity to submit in response to this solicitation and will not be discriminated against on the grounds of race, color, or national origin in consideration for an award.

The proposed contract is subject to 49 CFR Part 26 concerning the participation of Disadvantaged Business Enterprises (DBE).

The DBE goal for the design phase of the current project is **0%**. The goal will be re-set for the construction phase.

To assist in your qualification statement preparation, the criteria, project diagram, and most recent Airport Layout Drawing is available online

<http://www.dot.state.tx.us/avn/avninfo/notice/consult/index.html> by selecting "Houston County Airport." The qualification statement should address a technical approach for the current scope only.

**Response Procedure:**

The successful firm will be selected on the basis of a Response. A prime provider may only submit one Response. If a prime provider submits more than one Response, that prime provider will be deemed non-responsive. The Response must contain the required information, and should address the recommended information, as listed below. Response submissions will be scored accordingly. If the Response is non-compliant with any of the following requirements, the Response may be

deemed non-responsive.

1. Qualifications Statement (QS) – The QS shall contain no more than **nine 8.5x11-inch single-sided pages**.
  - a. QS Format:
    - i. Readability – The submitter has latitude in formatting the QS for visual effectiveness. Graphics, tables, photos, and other visual aids are permitted within the nine allotted pages, except that Quick Response (QR) codes or other external link(s) are not permitted. There is no specific font, font size, color, or other formatting requirements, although a font size smaller than 10 is not recommended. Selection committee members may consider legibility and readability when scoring. Unreadable text will not be considered and may cause the QS to be deemed non-responsive. **It is the submitter's responsibility to provide a legible, readable document.**
  - b. QS Content - It is recommended the QS include:
    - i. The RFQ number, airport name, name of firm, firm address, email address, telephone number and contact information for key personnel. The response shall also identify each proposed project team member, each proposed member's time commitment to this project as a percentage of their total work week, and whether the proposed member is an employee of the responding firm or a sub-contractor to that firm.
  - c. QS Content – For scoring purposes, the QS **must** include:
    - i. Information showing the firm's project understanding and technical approach, including similar project-related experience of the project manager and each task leader responsible for a major work category. For each project referenced, identify either the project manager's or the task leader's specific role(s) and work contributed. The project manager is required to be a Professional Engineer registered or licensed in Texas, by the submission deadline. If applicable to project, an Architect, is required to be registered or licensed in Texas, by the submission deadline. License number(s) must be included in the response submission.
    - ii. In addition to individual project-related experience of the project manager and task leaders required under (ii), list no more than ten relevant projects performed by the responding firm within the last 10 years. This shall include project start date, airport name, location, phone number, and airport contact person's name, title, and phone number. It shall also include the original project completion time estimate vs. the actual completion time for the cited design project, as well as

a brief narrative description of the project and whether or not your firm served as the prime or the sub on each project cited.

- iii. Project Design Schedule: Indicate the number of **weeks** (not months) necessary to design the project in accordance with “Project Design Schedule Information” below.

Respondent **must** include on the first page of its Response a written certification that the responding Company, or any of its holding companies or subsidiaries, is not:

- (a) Listed in Section 889 of the 2019 National Defense Authorization Act;
- (b) Listed in Section 1260H of the 2021 National Defense Authorization Act; or
- (c) Owned by the government of a country on the U.S. Department of Commerce’s foreign adversaries list under 15 C.F.R Section 791.4; or
- (d) Controlled by any governing or regulatory body located in a country on the U.S. Department of Commerce’s foreign adversaries list under 15 C.F.R Section 791.4.

The Response must be submitted in eGrants following the Submission Procedures at the end of this notice.

### **Project Design Schedule Information**

Based on the published project scope and your technical approach, indicate the number of **weeks** (not months) necessary for each phase and total design time to design the project. Some of the basic responsibilities within each design phase are included for reference. Do not include TxDOT review time. Assume, however, that your work will require some revision after TxDOT review, and that the time required to address these comments should be included within your schedule. If time is required for specialized studies, indicate the additional time.

**NOTE:** This proposed schedule may set the basis for the contract deadlines in the professional services agreement if your firm is selected. A draft contract will be sent out to the selected firm to begin the fee proposal/negotiations phase.

### **Preliminary Report Phase**

Attend pre-design conference  
Obtain and analyze necessary survey data  
Obtain and analyze necessary geotechnical data  
Prepare comprehensive report

### **Preliminary Design Phase**

Attend project meeting(s)  
Prepare project drawings (70%)

Provide all technical specifications  
Provide project cost estimate

**Final Design Phase**

Attend project meeting(s)  
Finalize drawings and contract documents (100%)  
Provide a revised opinion of probable total project costs  
Prepare a Construction Management Plan  
Update, if necessary, the Preliminary Report  
Prepare and submit airspace study to FAA

**Evaluation Criteria for Architectural/Engineering Qualifications**

**1. Recent experience of the project team with comparable airport projects within the past ten years. (25 points)**

Do the qualifications indicate that the project team has recent direct experience on other general aviation airports designing similar improvements to those proposed at this location?

**2. Proposed technical approach (30 points)**

Does the architect/engineer provide evidence of understanding of the project; and any unique architectural/engineering aspects associated with the proposed project and how to address them?

**3. Project design schedule and ability to meet schedules and deadlines (25 points)**

Does the proposed design team have sufficient time to work on this project? Has the firm demonstrated an ability to meet design schedules in the past? Reasonableness of proposed schedule.

**4. Construction Management Experience (20 points)**

The architect/engineer will oversee the airport construction. Therefore, it is critical that the architect/engineer be involved in the day-to-day construction activities through a full-time resident project representative and periodic site visits. What evidence do the qualifications provide as to the architect/engineer's commitment to proactive and consistent representation during construction?

**Submission Procedure:**

The completed Response must be received in the TxDOT Aviation eGrants system no later than December 30, 2025, 2:00 PM. (CST).

Firms that wish to submit a Response to this solicitation must be a user in the TxDOT Aviation eGrants system no later than one business day before the solicitation due date. To request access to eGrants, please complete the Contact Us web form located at <http://txdot.gov/government/funding/egrants-2016/aviation.html>

The consultant selection committee will be composed of Aviation Division staff. The final selection by the committee will generally be made following the completion of review of Responses. The committee will review all Responses and rate and rank each. All firms will be notified, and the top-rated firm will be contacted to begin fee negotiations for the design and bidding phases. The selection committee does, however, reserve the right to conduct interviews for the top-rated firms if the committee deems it necessary. If interviews are conducted, selection will be made following interviews.

Please contact TxDOT Aviation for any technical or procedural questions at (800)-68-PILOT(74568). For procedural questions, please contact Kelle Chancey. For technical questions, please contact Ryan Hindman, P.E., Project Manager.

For questions regarding responding to this solicitation in eGrants, please contact the TxDOT Aviation help desk at 1-800-687-4568 or [avn-egrantshelp@txdot.gov](mailto:avn-egrantshelp@txdot.gov).

Respondents are responsible for checking the TxDOT Aviation website regularly for any changes to the RFQ documents, such as Addenda. Here is a link to the TxDOT Aviation website for your convenience. <http://www.txdot.gov/inside-txdot/division/aviation/projects.html>.



## Aviation Division

eGrants Workflow:	<b>RFQ Response</b>		
eGrants Role:	Subgrantee Administrator (SA) Subgrantee Staff (SS)		
eGrants link	<a href="https://apps2.dot.state.tx.us/apps/egrants2/logout2.aspx">https://apps2.dot.state.tx.us/apps/egrants2/logout2.aspx</a>		
eGrants help:	eGrants help desk Monday – Friday 8AM – 4PM CD/ST (excluding state/federal holidays) <a href="mailto:avn-egrantshelp@txdot.gov">avn-egrantshelp@txdot.gov</a> or 1-800-687-4568		
STEP	ROLE	ACTIONS	NOTES
01	SA	Go to View Opportunities. a. Select <u>Apply Now</u> to the opportunity b. The RFQ Response Menu is opened	Very important to click on the name of the document and not the organization name.  Make a note of the opportunity due date to ensure you respond in time
02	SA/SS	Click on View, Edit and Complete Forms a. Select RFQ Applicant Form b. Confirm Project information and address c. Upload RFQ response <u>PLEASE MAKE SURE YOU SELECT THE CORRECT PDF FILE BEFORE CHANGING STATUS.*</u> d. Hit Save	You should print the proposal document to a PDF so that it becomes un-editable.
03	SA	When you are ready to submit your response, click on " <u>Save and submit to CS review</u> ". YOU ARE DONE	You will get an email saying the response was successfully submitted; the status must be changed to RFQ Response in CS Review by the due date and time posted in the solicitation.
04	SA/SS	WAIT UNTIL A SELECTION NOTIFICATION IS SENT TO YOU	

05	SS/SA	<u>AFTER SELECTION NOTIFICATION IS RECEIVED</u> Log in to view status of response. Once the scores are verified, TxDOT will move the response to an interview, selected or not selected status of which you can log in to see the status of your response.	The selection notification will refer users to eGrants to view the status of their response. User may also view the TxDOT website for selection information.

\*If the responder posts the incorrect file.

- If status has been changed and the due date for the response has not expired, contact the help desk to ask for the status to be administratively changed back to Response in Process.
- If the incorrect submission was posted, the incorrect file may be deleted and the correct one posted as long as the status has not been changed to Response in CS Review. Respondent will need to check the “delete” box and hit save. The page refreshes. Then post the correct submission, save, and change the status.

If you are not set up in eGrants and wish to respond to a posted solicitation, you may contact the aviation help desk for assistance by using the webform available at

[\*\*eGrants Help Desk Form\*\*](#)

Some organizations will have many user members. Each organization should determine which user member will submit the completed submission in eGrants. After the opportunity is selected for the organization, it will no longer appear on any other user’s home page unless the initiating user cancels the response.



- 1. INSTALL MIRL RUNWAY (2/20)
- 2. INSTALL PAPI RUNWAY (2/20)
- 3. INSTALL NEW VAULT
- 4. INSTALL NEW SIGNS
- 5. INSTALL MISCELLANEOUS Eligible ITEMS



INSTALL PAPI RUNWAY (2/20)

INSTALL MIRL RUNWAY (2/20)

	TEXAS DEPARTMENT OF TRANSPORTATION	AVIATION DIVISION
HOUSTON COUNTY AIRPORT (DKR)		

BUILDINGS/FACILITIES				
EXISTING	ULTIMATE	ELEVATION	PROPOSED OBJECT DISPOSITION	DESCRIPTION
1		370.6'	REQUEST FAA AERONAUTICAL STUDY	CONVENTIONAL HANGAR
2		370.8'	REQUEST FAA AERONAUTICAL STUDY	T-HANGAR
3		372.1'	REQUEST FAA AERONAUTICAL STUDY	CONVENTIONAL HANGAR
4		367.0'		PILOT LOUNGE
5		377.2'		CONVENTIONAL HANGAR
6		379.2'		CONVENTIONAL HANGAR
7		374.8'	REQUEST FAA AERONAUTICAL STUDY	CONVENTIONAL HANGAR
8		363.7'		CONVENTIONAL HANGAR
9		370.1'		CONVENTIONAL HANGAR
10		370.8'		CONVENTIONAL HANGAR
	11			T-HANGAR
	12-16			CONVENTIONAL HANGAR

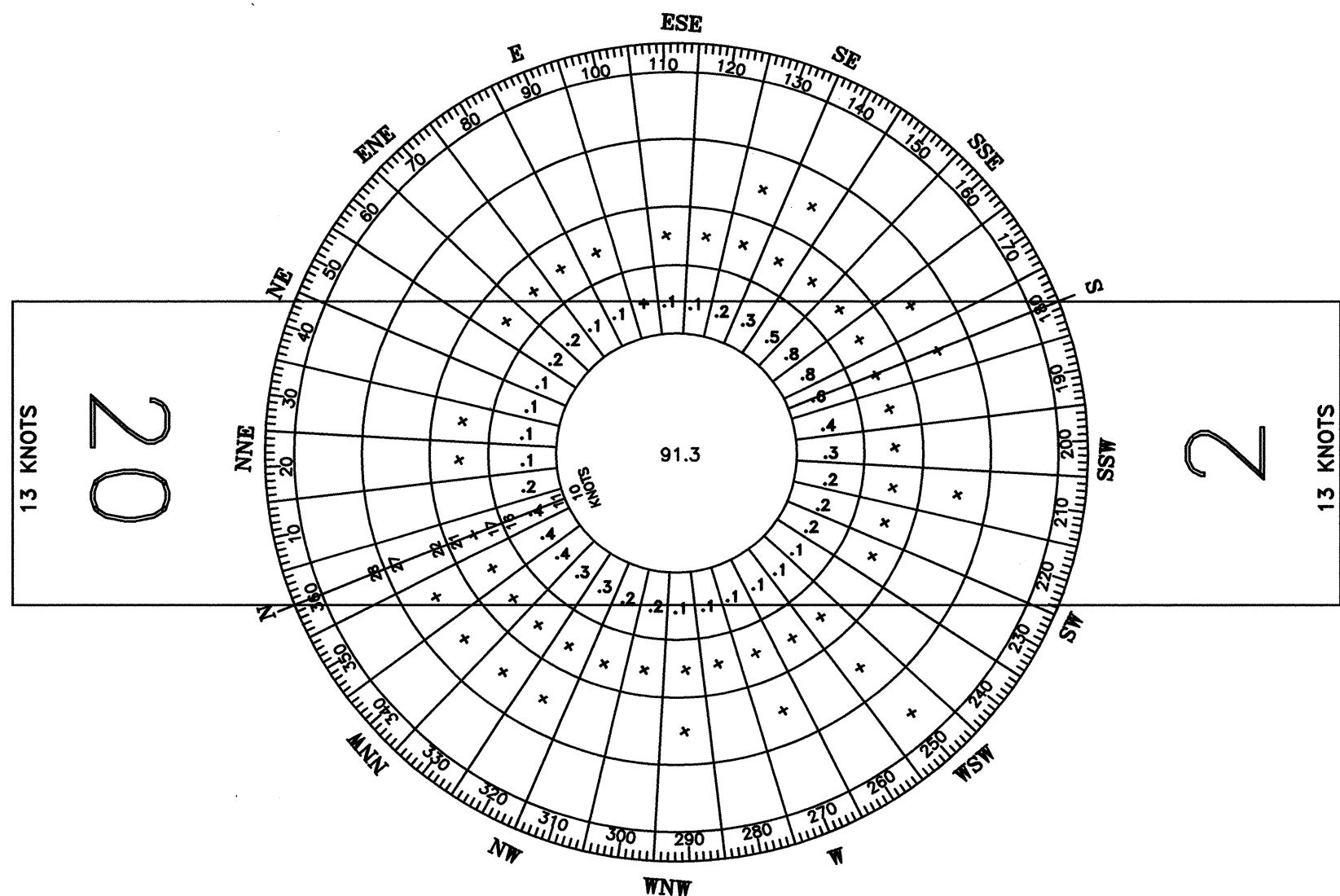
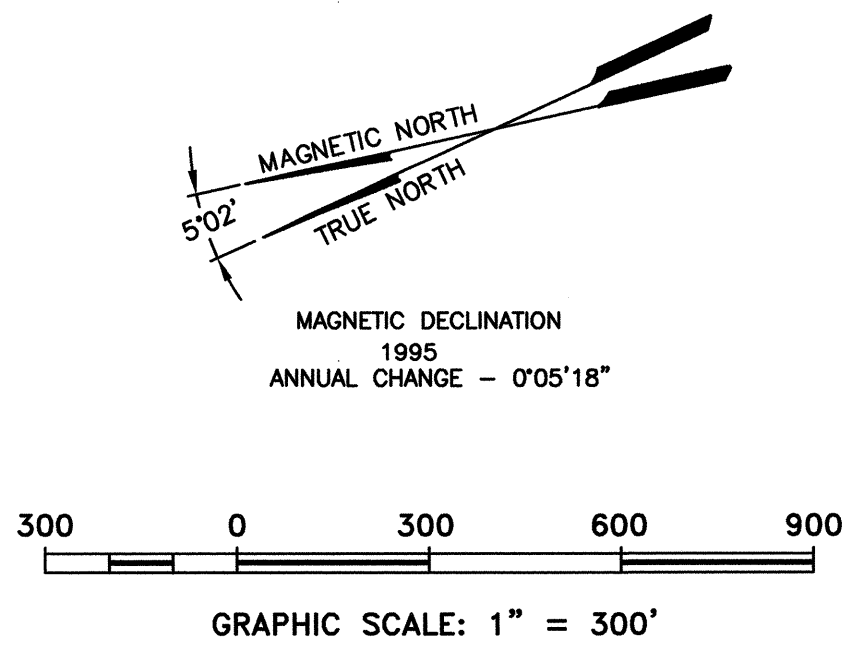

## HOUSTON COUNTY AIRPORT WIND DATA

13 KNOT CROSSWIND  
SOURCE: LUFKIN, ANGELINA COUNTY  
PERIOD: 1981-1992 (ALL WEATHER)  
WIND COVERAGE 98.89%, 13 KNOTS  
PERCENT CALM 17.6%

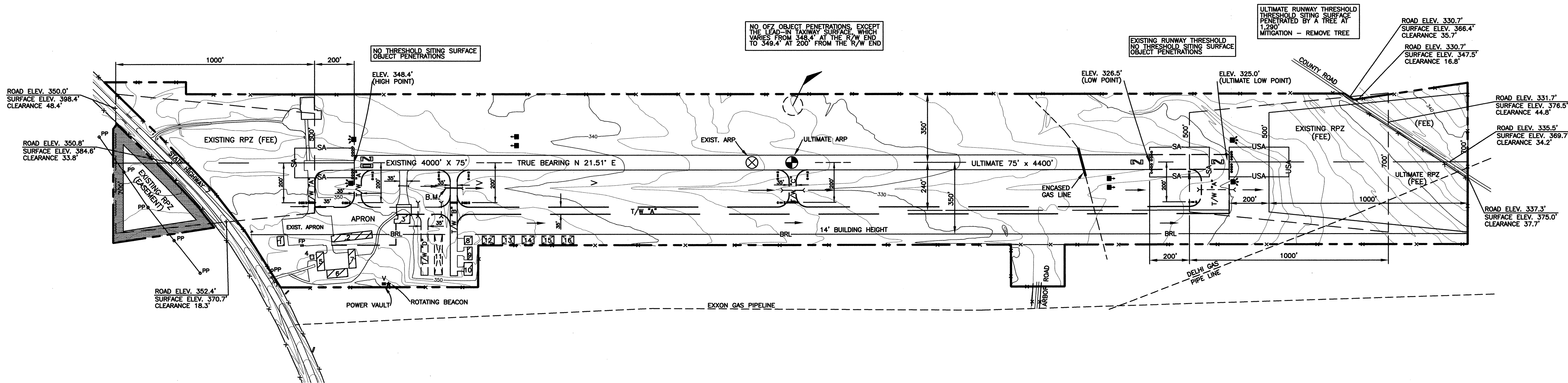

AIRPORT BENCH MARK  
BRASS MONUMENT SET IN THE TOP OF  
CULVERT HEADWALL ON THE NORTH SIDE  
OF TAXIWAY "B"  
ELEVATION 343.48'

RUNWAY DATA	RUNWAY 2-20	
	EXISTING	ULTIMATE
APPROACH CATEGORY	B-II	B-II
APPROACH VISIBILITY MINIMUMS	V / V	1 MILE / 1 MILE
RUNWAY DIMENSIONS, FEET	4,000 x 75	4,400 x 75
RUNWAY APPROACH SURFACE	20:1	20:1
SAFETY AREA, FEET	4,600 x 150	5,000 x 150
OBJECT FREE AREA, FEET	4,600 x 500	5,000 x 500
OBSTACLE FREE ZONE, FEET	4,400 x 250	4,800 x 250
TAKE OFF RUN AVAILABLE (TORA)	4,000 - 4,000	4,400 - 4,400
TAKE OFF DISTANCE AVAILABLE (TODA)	4,000 - 4,000	4,400 - 4,400
ACCELERATE - STOP DISTANCE AVAILABLE (ASDA)	4,000 - 4,000	4,400 - 4,400
LANDING DISTANCE AVAILABLE (LDA)	4,000 - 4,000	4,400 - 4,400
PAVEMENT MATERIAL	ASPHALT	ASPHALT
PAVEMENT STRENGTH (SW) LBS.	12,500	12,500
RUNWAY EFFECTIVE GRADIENT, %	0.547	0.508
TOUCHDOWN ZONE	342.3 / 348.4	339.7 / 348.4
MARKING	NPI	NPI
LIGHTING	MIRL	MIRL
VISUAL APPROACH AIDS	SAVASI	PAPI/REILS
TAXIWAY LIGHTING	NONE	GUIDANCE SIGNS
TAXIWAY MARKING	STD. W/REFLECTORS	STD. W/REFLECTORS
RUNWAY NAVIGATIONAL AIDS	NONE	GPS

RUNWAY END COORDINATES (NAD 83)			
RUNWAY	EXISTING	ULTIMATE	
RUNWAY 2	LATITUDE 31°18'06.642" N	31°18'02.960" N	
	LONGITUDE 95°24'22.243" W	95°24'23.933" W	
RUNWAY 20	LATITUDE 31°18'43.473" N	31°18'43.473" N	
	LONGITUDE 95°24'05.338" W	95°24'05.338" W	

RUNWAY END COORDINATES AND ELEVATIONS  
DETERMINED BY BOB KURANEK, R.P.L.S., TX, 1944  
GEODETIC, INC., SAN ANTONIO, TX, MAY 1998  
METHOD OF SURVEY:  
GPS STATIC AND KINEMATIC METHODS USING  
TRIMBLE 4000SSE GEODETIC RECEIVERS  
DATUM:  
HORIZONTAL - NAD 83  
VERTICAL - NAVD 88  
GEOID - GEOID 98SE  
HORIZONTAL CLOSURE: 1/4,000,000  
VERTICAL CLOSURE: 0.01" IN 12.5 MILES

AIRPORT DATA TABLE		
ITEM	EXISTING	ULTIMATE
AIRPORT DESIGN	BU-II	GU-IA
AIRPORT REFERENCE CODE	B-II	B-II
AIRPORT ELEVATION, FEET MSL	348.4	348.4
MEAN MAXIMUM TEMPERATURE OF HOTTEST MONTH	95° F	95° F
AIRPORT REFERENCE	LATITUDE 31°18'25.058" N	31°18'23.216" N
POINT (ARP) NAD 83	LONGITUDE 95°24'13.791" W	95°24'14.636" W
AIRPORT/TERMINAL VISUAL AIDS	ROTATING BEACON	ROTATING BEACON
AIRPORT/TERMINAL NAVIGATIONAL AIDS		GPS

- NOTES
1. DEPICTION OF FEATURES AND OBJECTS, INCLUDING RELATED ELEVATIONS AND CLEARANCES, WITHIN THE RUNWAY PROTECTION ZONES ARE DEPICTED ON THE INNER APPROACH PLANS.
  2. RECOMMENDED LAND USES WITHIN THE AIRPORT ENVIRONS ARE DEPICTED ON THE AIRPORT LAND USE PLAN.
  3. BUILDING RESTRICTION LINE (BRL) IS ESTABLISHED IN ACCORDANCE WITH F.A.R. PART 77 CRITERIA. BUILDING HEIGHT SHOWN IS HEIGHT ABOVE THE ADJACENT RUNWAY CENTER LINE ELEVATION. ON EAST SIDE OF THE RUNWAY, THE BRL IS CONTIGUOUS WITH THE AIRPORT PROPERTY LINE.

LEGEND		
EXISTING	ULTIMATE	ITEM
		PROPERTY LINES
		AIRPORT REFERENCE POINT
		ROTATING BEACON
		AVIGATION EASEMENT (IF APPLICABLE)
		BUILDING CONSTRUCTION
		BUILDING RESTRICTION LINE (BRL)
		FACILITY CONSTRUCTION
		FENCING
		THRESHOLD LIGHTS
		SAVASI
		2 BOX PAPI
		RUNWAY END IDENTIFIER LIGHTS (REIL)
		WIND CONE AND SEGMENTED CIRCLE
		SAFETY AREA
		TOPOGRAPHY
		ELECTRIC VAULT
		FUEL STORAGE AREA
		GUIDANCE/HOLD LINE SIGN

NO.	REVISIONS	BY	CHK'D	DATE

TEXAS DEPARTMENT OF TRANSPORTATION AVIATION DIVISION <input checked="" type="checkbox"/> ALP APPROVED ACCORDING TO FAA AC 150/5300-13 CH 5 PLUS THE REQUIREMENTS OF A FAVORABLE ENVIRONMENTAL FINDING PRIOR TO THE START OF ANY LAND ACQUISITION OR CONSTRUCTION AND AN FAA FORM 7460-1 SUBMITTED PRIOR TO ANY CONSTRUCTION ON AIRPORT PROPERTY <input type="checkbox"/> ALP APPROVED ACCORDING TO FAA AC 150/5300-13 CH 5 PLUS THE CONDITIONS/COMMENTS IN LETTER DATED:	AIRPORT SPONSOR CURRENT AND FUTURE DEVELOPMENT DEPICTED ON THIS ALP IS APPROVED AND SUPPORTED BY AIRPORT SPONSOR  <i>R.C. von Doerhoff</i> TITLE: AIRPORT SPONSOR REPRESENTATIVE SIGNATURE: <i>R.C. von Doerhoff</i> DATE: 2-3-99
PREPARED BY: <b>The Brannon Corporation</b> ENGINEERS, SURVEYORS, & URBAN PLANNERS 1321 SOUTH BROADWAY • TYLER, TEXAS 75701 (936) 487-8188 (936) 487-8888 FAX	B.F.L. DESIGNED BY: NOVEMBER 1998 DATE: R.L.R. DRAWN BY: NOVEMBER 1998 DATE: CHECKED BY: DATE:

AIRPORT LAYOUT DRAWING HOUSTON COUNTY AIRPORT CROCKETT, TEXAS	 Texas Department of Transportation Aviation Division SHEET 2 OF 8
---	---